

Butterfly Isolating Valves with Electric Actuator



- $p_{max.}$ PN 16
- $t_{max.}$ +160 °C
- Flanges DN 40 to DN 80
- 24 V_{DC}, 230 V_{AC}
- Body:
GGG-40, aluminium
- Butterfly disc:
stainless steel, steel
- Seals: EPDM, FKM



KOBOLD companies worldwide:

ARGENTINA, AUSTRIA, BELGIUM, CANADA, CHILE, CHINA, CZECHIA,
FRANCE, GERMANY, GREAT BRITAIN, INDIA, INDONESIA, ITALY,
MALAYSIA, MEXICO, NETHERLANDS, POLAND, SINGAPORE, SLOVAKIA,
SPAIN, SWITZERLAND, THAILAND, USA, VENEZUELA, VIETNAM

KOBOLD Messring GmbH
Nordring 22-24
D-65719 Hofheim/Ts.
☎ +49(0)6192 299-0
Fax +49(0)6192 23398
E-Mail: info.de@kobold.com
Internet: www.kobold.com

Model:
KLE-TA



Design

One-piece construction. For mounting between two flanges.
 Operation: directly controlled by an electric motor, with gear reduction unit between motor and valve assembly
 Voltage rating: 230 V_{AC} 50 Hz ±10% or 24 V_{DC}
 Mounting position: any; preferably with electric motor in upright position
 Protection type: IP 65 (as per DIN 40 050)
 Cable connection: PG 11
 Standard equipment: two additional limit switches, optical position indicator, emergency manual operation

Technical Details valve

Connections: flanges DN 40 to DN 80
 overall length as per DIN 3202KI
 Temperature range: EPDM: -35°C to +120°C
 FKM: -20°C to +160°C

Operating pressure
 • between 2 flanges: max. 16 bar (GGG-body)
 max. 10 bar (alu-body)
 max. 6 bar
 • end valve:

Materials

Body: spheroidal graphite cast iron GGG-40, aluminum alloy
 Disc: 1.4408, steel C22 (only KLE-TAH)
 Shaft seal: NBR
 Shaft: stainless steel 1.4016, 1.4571
 Bushing: bronze
 Sleeve: EPDM, FKM

KLE-TA

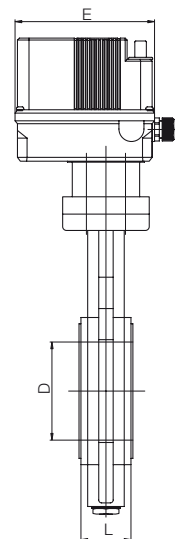
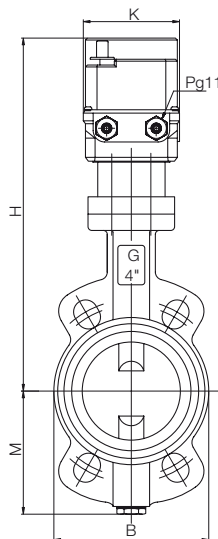

Dimensions

Flange [DN]	D [mm]	B [mm]	L [mm]	H [mm]	M [mm]	K [mm]	E [mm]	Operating time [s/90°]	Power consumption [VA]	Weight [kg]
40	49	84	33	318	75	100	145	15	15	4.4
50	55	102	43	326	81	100	145	15	15	5.3
65	68	116	46	336	89	124	169	15	15	7.0
80	81	133	46	346	110	124	169	15	15	7.5

Order Details (example: KLE-TA 7 E F40 0)

Order no.	Body	Seal	Connection size	Voltage
KLE-TA	7 = Aluminium H = GGG-40	E = EPDM F = FKM	F40 = DN 40 F50 = DN 50 F65 = DN 65 F80 = DN 80	0 = 230 V _{AC} 3 = 24 V _{DC}